

DETALLE S10

ESC.1/2

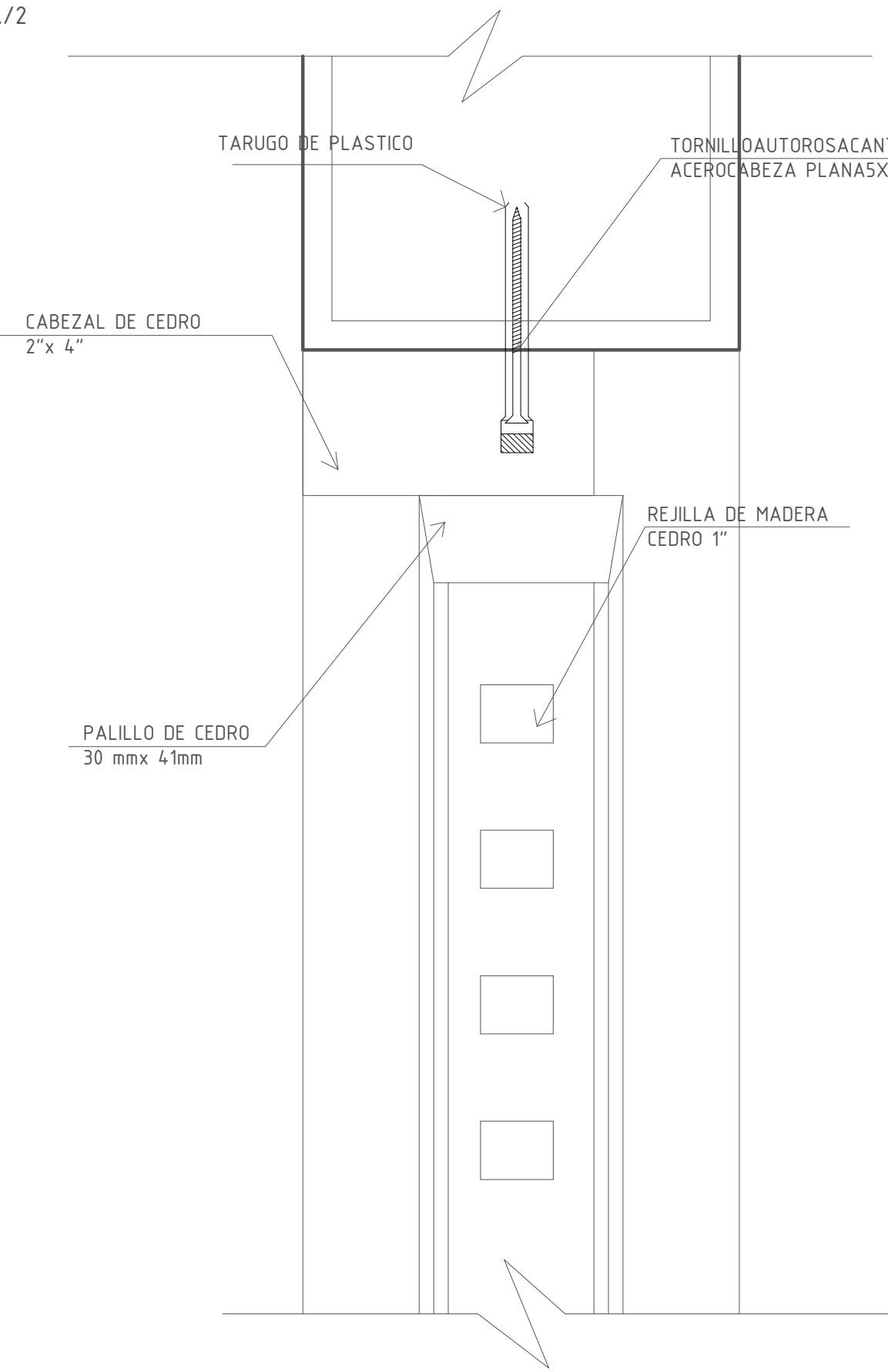

DETALLE S12

ESC.1/2

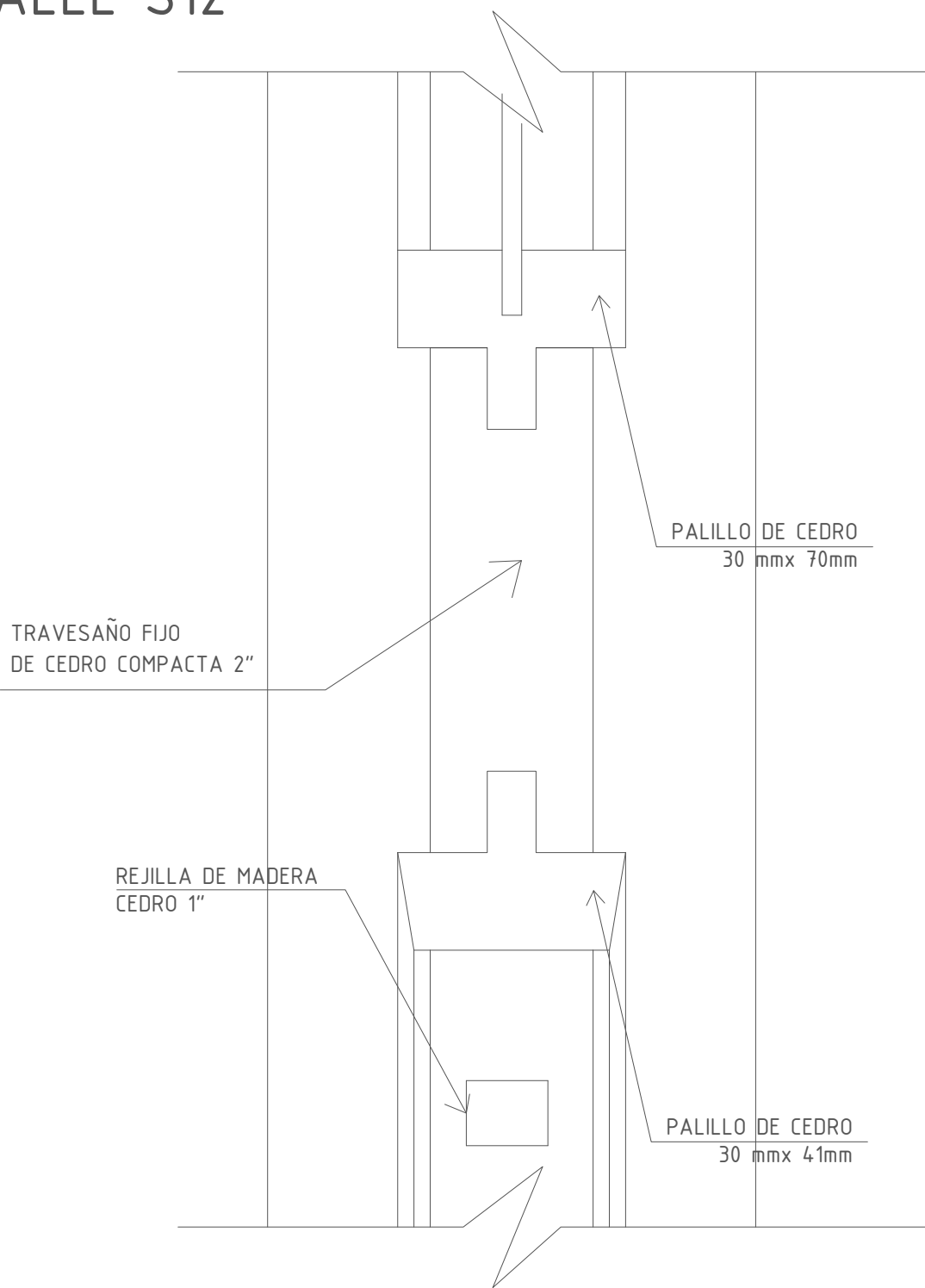

DETALLE S15

ESC.1/2

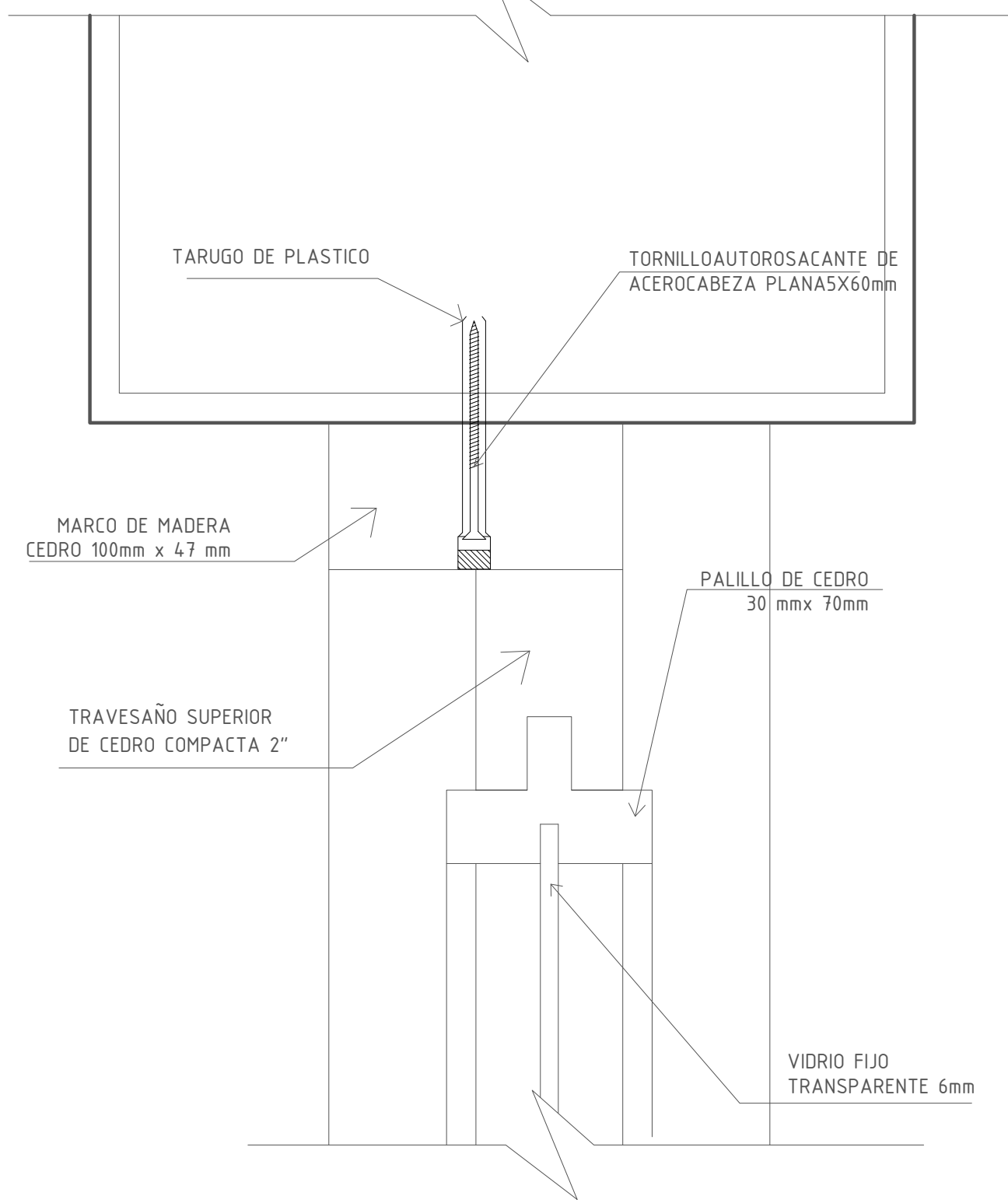

DETALLE S16

ESC.1/2

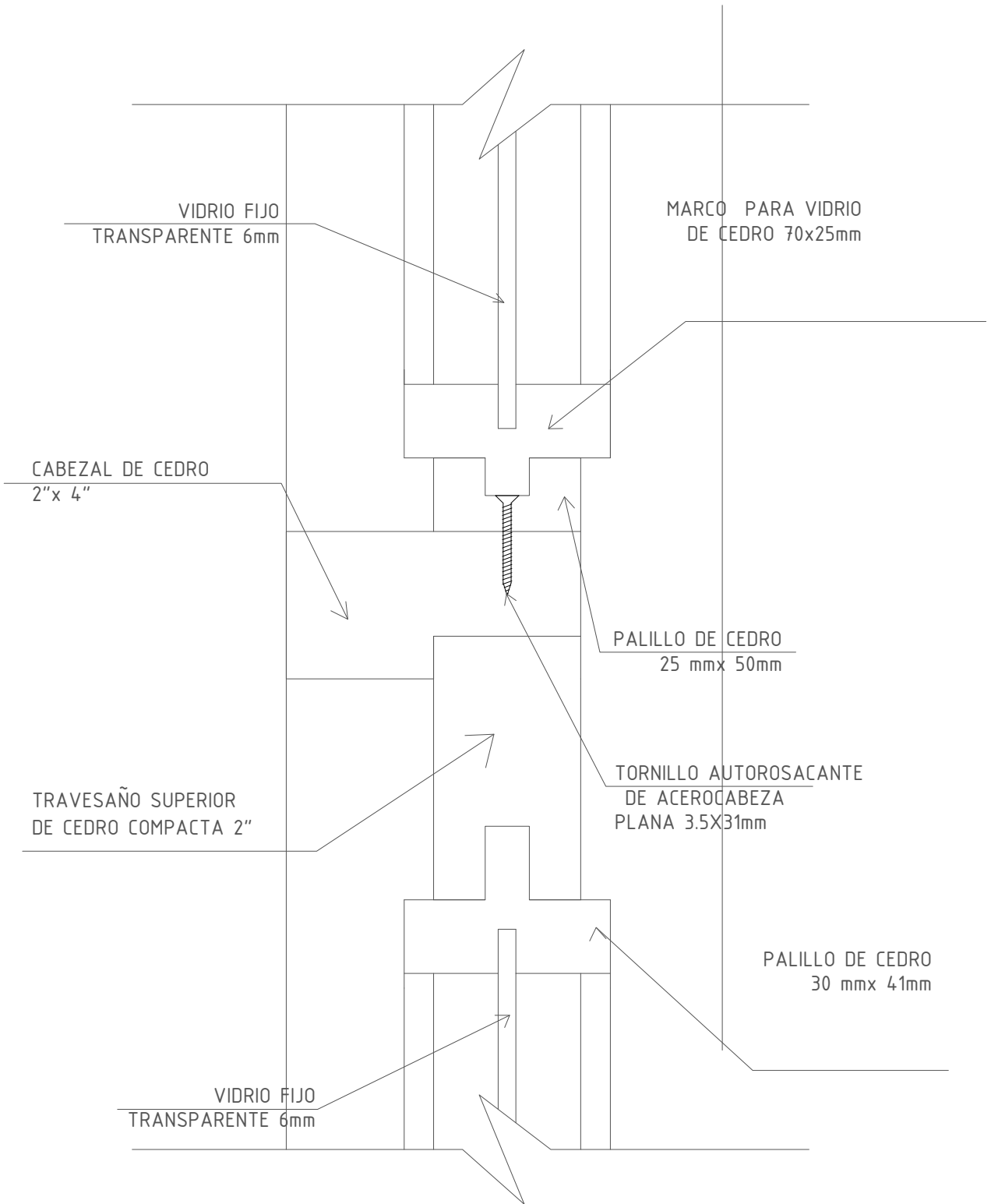

DETALLE S17

ESC.1/2

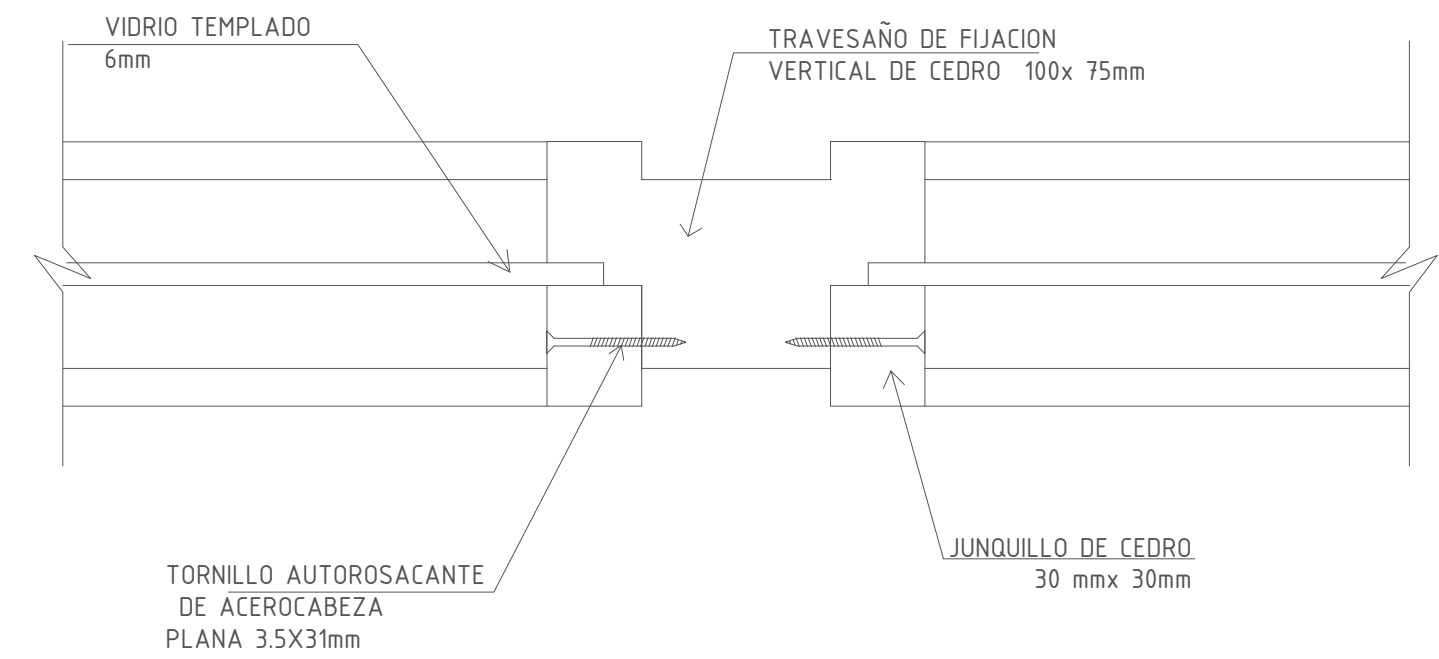

DETALLE S19

ESC.1/2

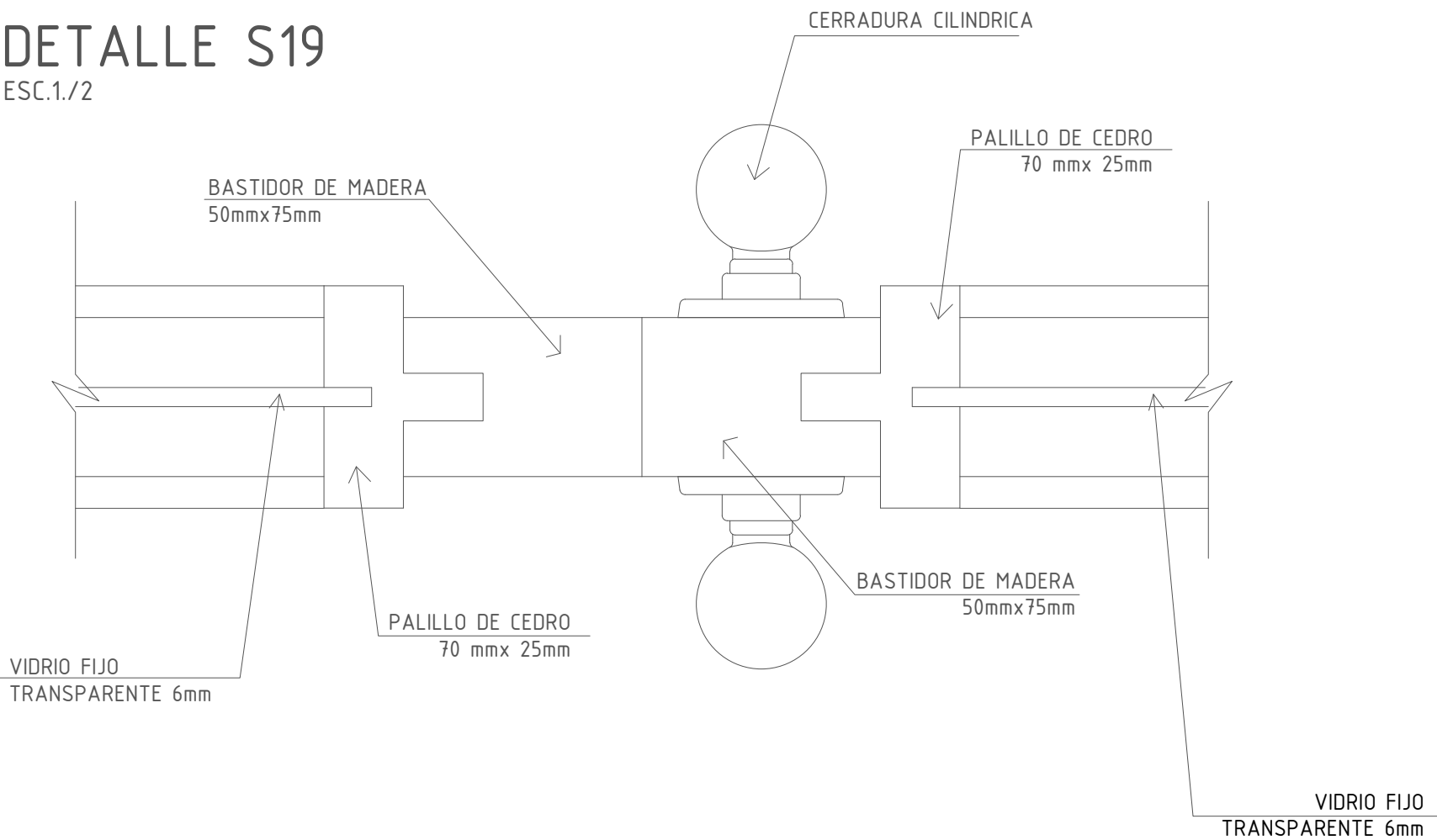

DETALLE S11

ESC.1/2

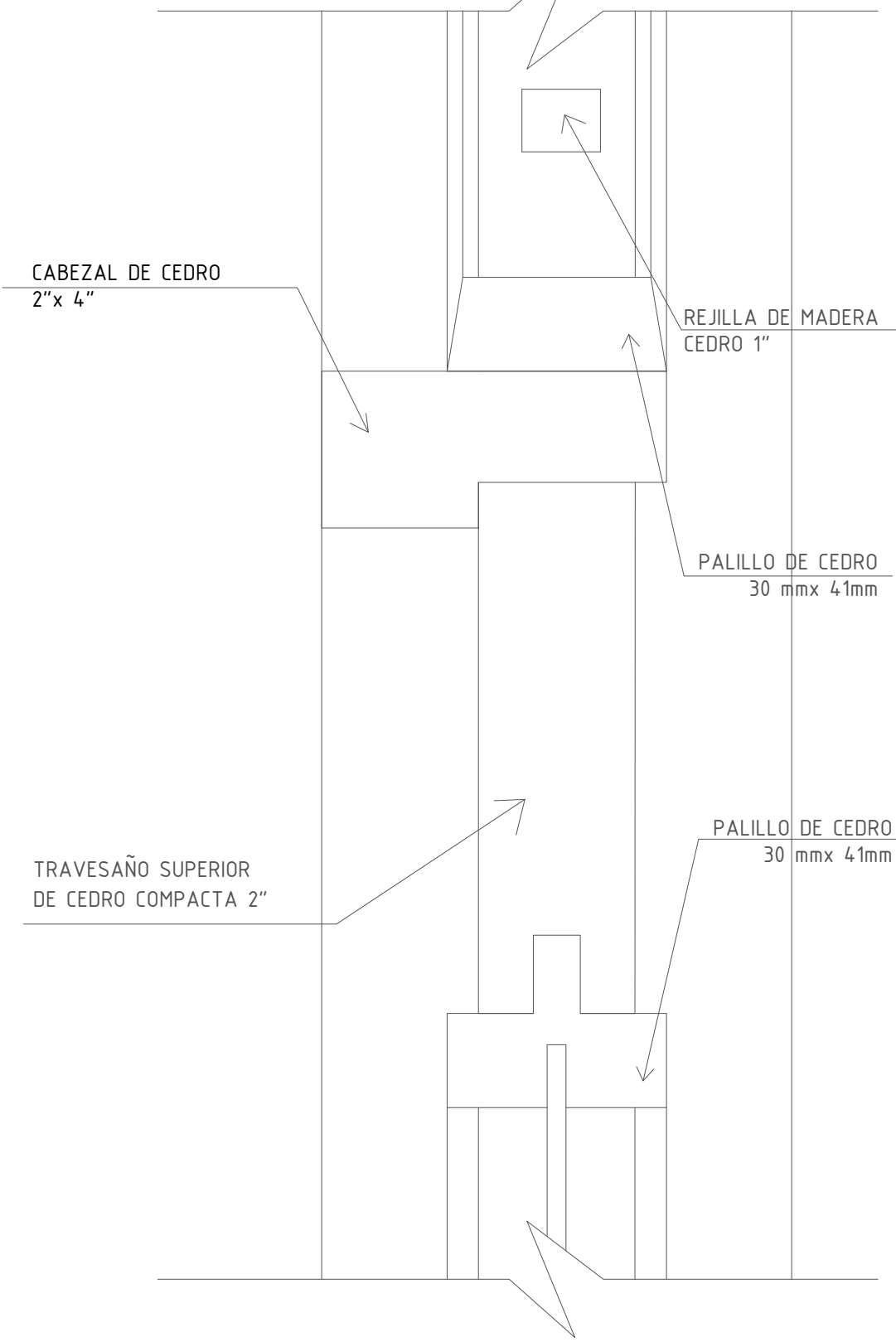

DETALLE S13

ESC.1/2

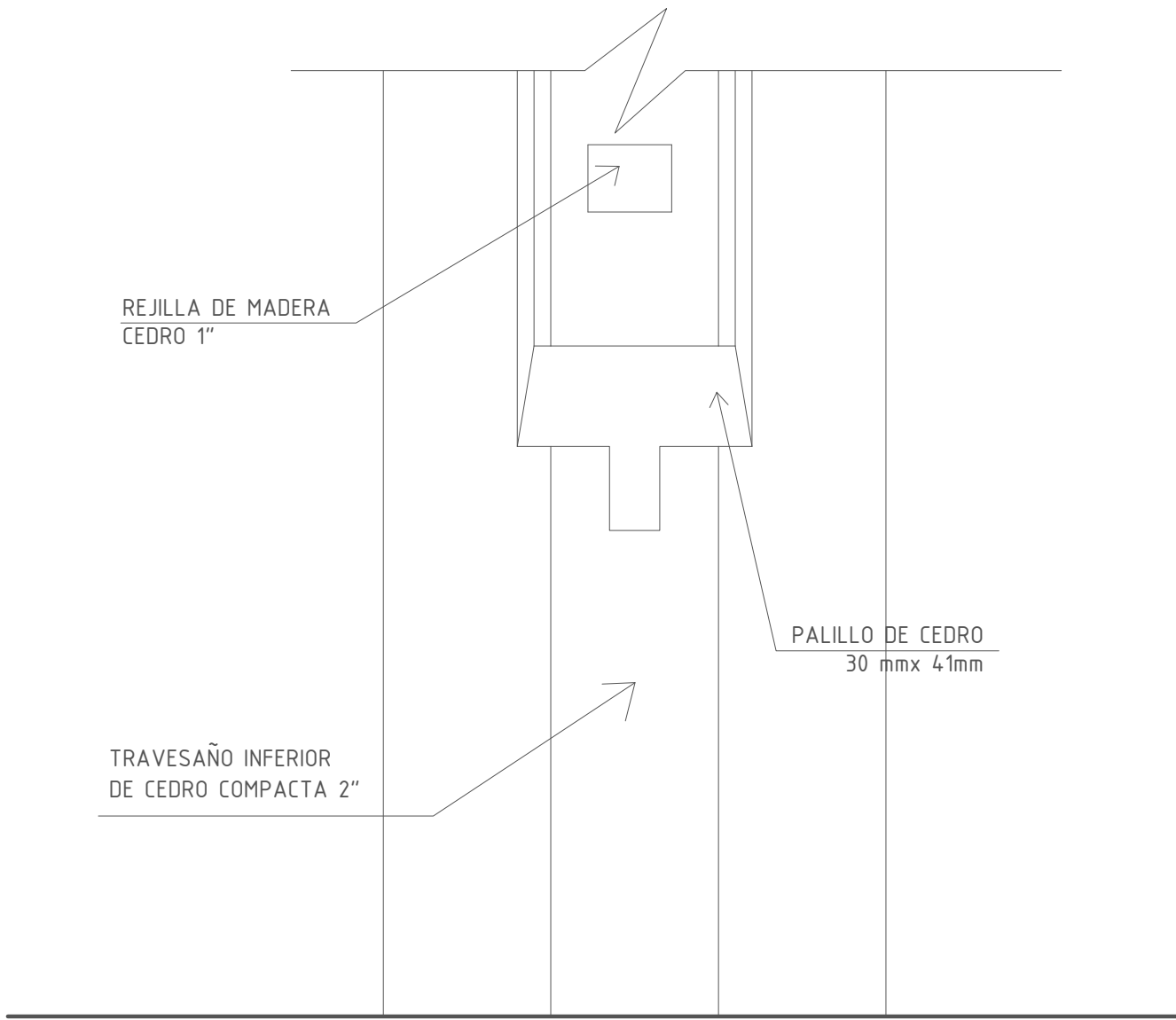

DETALLE S18

ESC.1/2

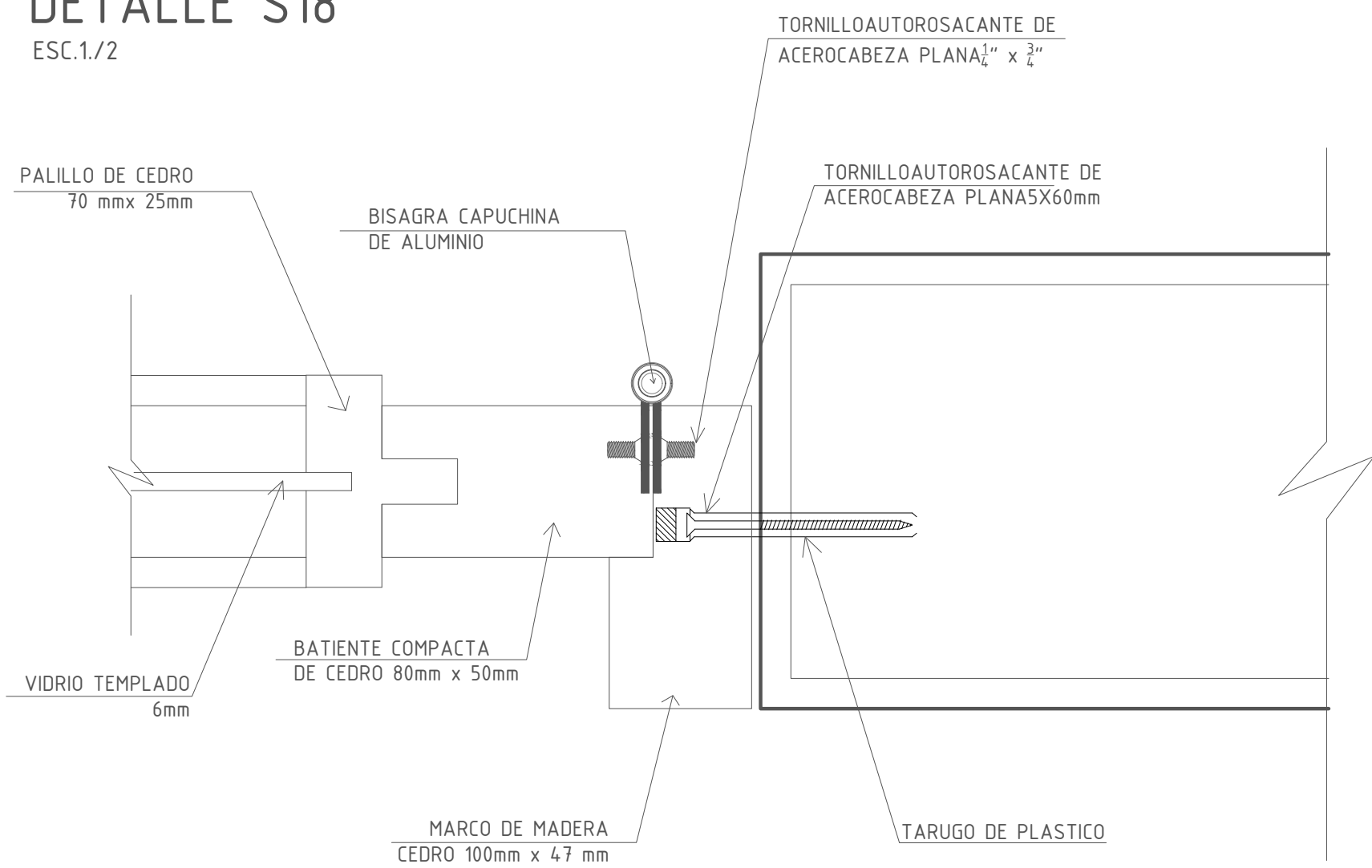

DETALLE S20

ESC.1/2

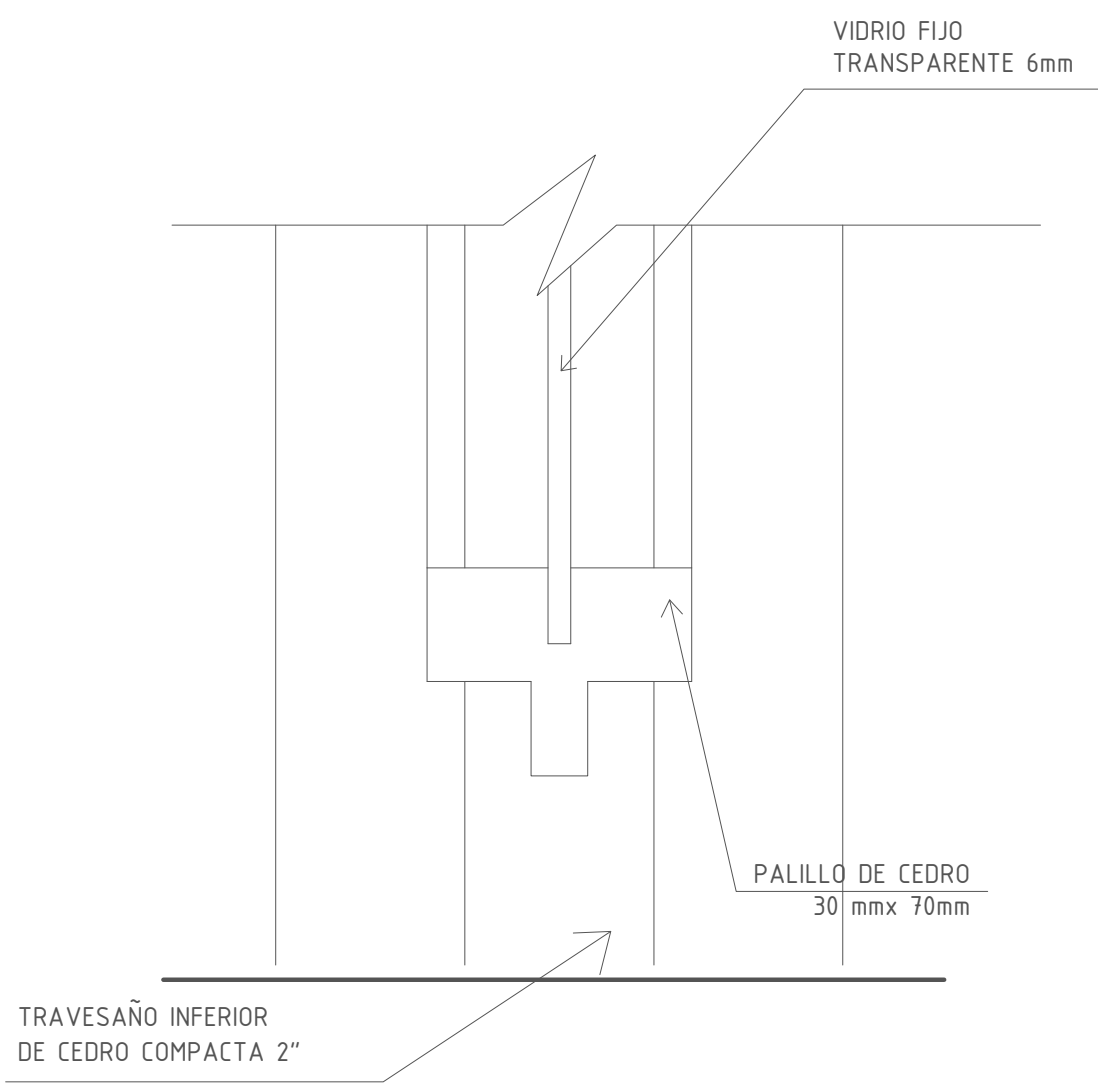

DETALLE S21

ESC.1/2

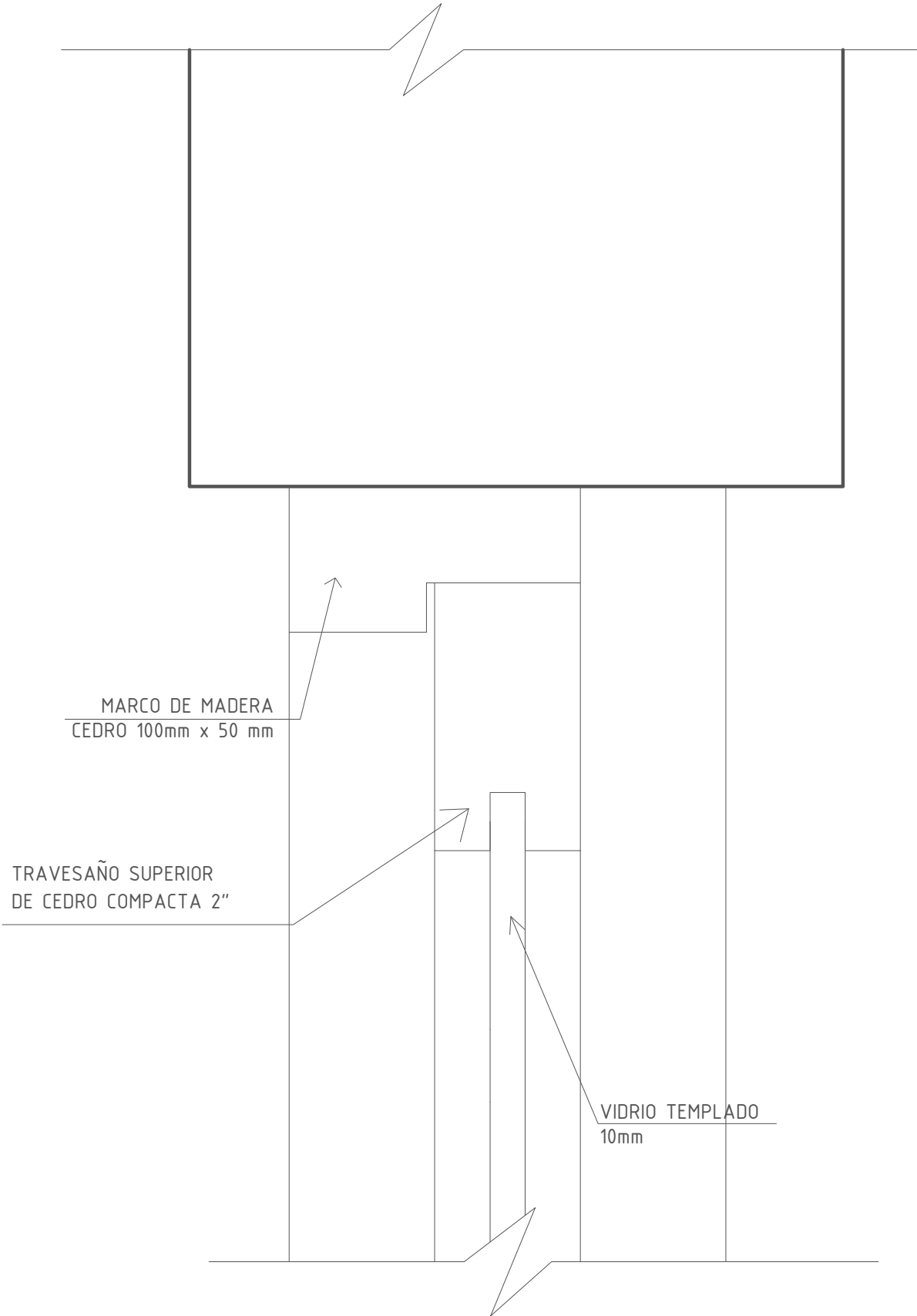

DETALLE S14

ESC.1/2

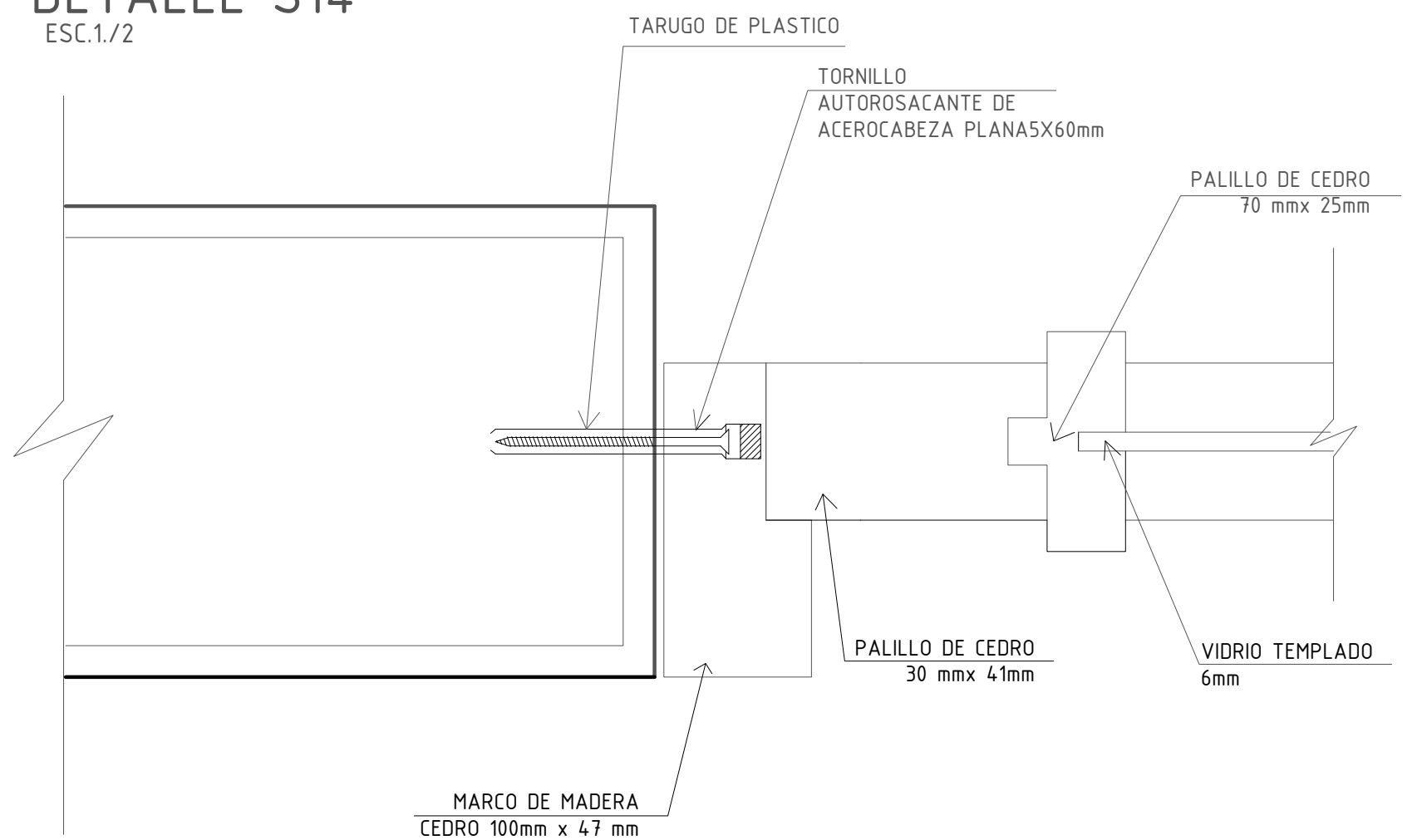

CUADRO DE VANOS				
	TIPO	ANCHO	MEDIDAS ALTURA	OBSERVACIONES
PUERTA	P ₀₁	1.80	2.10	Corrediza
	P ₀₂	1.00	2.10	
	P ₀₃	0.90	2.10	-----
	P ₀₄	0.65	2.10	-----
	P ₀₅	1.20	2.10	Batiente
	P ₀₆	2.05	2.10	-----
	P ₀₇	0.70	2.10	-----
	P ₀₈	0.60	2.10	-----
VENTANAS Y VANOS	01	4.30	0.65	-----
	02	2.15	1.10	-----
	03	1.85	2.74	-----
	04	4.30	2.74	-----
	05	2.25	2.74	Batiente
	06	1.30	2.20	-----
	07	1.70	2.20	-----
	08	2.50	2.20	-----
	09	1.00	2.20	-----
	10	1.70	2.20	-----
	11	2.65	2.20	-----
	12	2.00	2.20	-----
PANTALLA	13	1.00	2.20	-----
	14	1.25	2.20	-----
	15	1.50	2.75	-----
	16	2.40	2.20	-----
	17	1.85	2.20	-----
	18	2.00	2.20	-----
	19	1.95	2.20	-----
	20	1.84	2.20	-----
	M ₀₁	4.30	2.75	Corrediza
	M ₀₂	1.82	2.75	Batiente
	M ₀₃	1.80	2.75	Batiente
	M ₀₄	1.10	2.75	Batiente
	M ₀₅	0.95	2.75	Fija
	M ₀₆	1.05	2.75	Fija
	M ₀₇	1.30	2.75	Fija
	M ₀₈	0.90	2.75	Batiente

PROYECTO:

VIVIENDAS PRODUCTIVAS
Y PROCESADORA DE TRUCHA
HUARAZ

ALUMNA:

VELÁSQUEZ LÓPEZ MARGARITA T.

DESCRIPCION:

DETALLE DE PUERTAS
Y VENTANAS

ESCALA:

1/2

FECHA:

JULIO 2021

PROFESIONAL RESPONSABLE:

ARQ. JORGE COSMÓPOLIS BULLÓN
ING. TOMAS CARRASCO ORELLANO
ING. LUIS ALBERTO RAMOS MARTINEZ
ING. JOSE CARLOS YAFAC RISCO

LAMINA:

D-08